

NR 24 / 36

All-In-One
Nebula Liquid CPU Cooler

User Manual



Product Video Information



NR Series Product Video



NR Series Installation Video

Product Story

Interstellar Cooling

High Performance AIO Liquid CPU Cooler NR Series will provide your build with stellar visual aesthetics. The water block is filled with crystal shimmering stars and the radiator is equipped with high static pressure fans Luna AL120. Gaze into the realms of Nebula!



Specifications

NR24



NR36



Model		NR24		NR36	
Model Number		IW-LC-NR24		IW-LC-NR36	
CPU Socket Support		Intel® LGA 1851/ 1700/ 1200/ 2066/ 2011-V3/ 2011/ 1366/ 1156/ 1155/ 1151/ 1150 AMD® AM5/ AM4/ AM3+/ AM3/ AM2+/ AM2/ FM2+/ FM2/ FM1/ TR4			
Radiator	Dimensions (L x W x H)	277 x 120 x 27 mm (10.9 x 4.7 x 1.1")		397 x 120 x 27 mm (15.6 x 4.7 x 1.1")	
	Materials	Aluminium			
	Tube Length	400 mm		450 mm	
	Tube Material	Rubber with Nylon Braided Sleeve			
Water Block	Dimensions (L x W x H)	87.3 x 75 x 68 mm (3.4 x 3.0 x 2.7")			
	Materials	Copper, Glass, Plastic			
Pump	Dimensions (L x W x H)	66 x 50 x 31 mm (2.6 x 2.0 x 1.2")			
	Materials	PPS GF			
	Pump Speed	5200 +/- 10% RPM			
Fan	Model	Luna Series AL120			
	Quantity Included	2 PCS		3 PCS	
	Dimensions (L x W x H)	120 x 120 x 25 mm (4.7 x 4.7 x 1.0")			
	Speed Mode	PWM 400-1800 +/- 10% RPM			
	Noise Level	25 dB(A) (Normal)			
	Airflow	82.96 CFM			
	Static Pressure	2.31 mm / H2O			
	Connectors	4-Pin (12V, PWM), 3-Pin (5V, ARGB)			
	Rated Voltage	DC 12V			
	Bearing Type	Long Lifespan Sleeve Bearing			
Package Dimensions (L x W x H)		331 x 265 x 136 mm (13 x 10.4 x 5.4")		459 x 244 x 136 mm (18.1 x 9.6 x 5.4")	
Net Weight		0.85 kg / 1.87 lb		1.05 kg / 2.31 lb	
Gross Weight		2.0 kg / 4.41 lb		2.45 kg / 5.4 lb	
Warranty		3 Years			

* InWin's products comply with RoHS regulation.

* Specifications may vary based on different regions.

NR24 Package Contents



a.	QR Code Card x1	k.	240 Radiator x1
b.	Intel Mounting Bracket x2	l.	ARGB Water Block Cable x1
c.	AMD Mounting Bracket x2	m.	ARGB Fan Cable x1
d.	Luna AL120 Fans x2	n.	PWM Fan Cable x1
e.	Intel CPU Backplate x1	o.	Washer x8
f.	Standoff Screws x4 (LGA 20XX)	p.	Fan Screws x8
g.	Standoff Screws x4 (LGA 115X/1200/1366)	q.	Radiator Screws x8
h.	Standoff Screws x4 (LGA 1700/1851)	r.	ARGB One-Click Controller x1
i.	Standoff Screws x4 (AMD)	s.	Thumbscrew Caps x4
j.	Standoff Screws x4 (TR4)	t.	Thermal Compound x1

NR36 Package Contents



a.	QR Code Card x1	k.	360 Radiator x1
b.	Intel Mounting Bracket x2	l.	ARGB Water Block Cable x1
c.	AMD Mounting Bracket x2	m.	ARGB Fan Cable x1
d.	Luna AL120 Fans x3	n.	PWM Fan Cable x1
e.	Intel CPU Backplate x1	o.	Washer x12
f.	Standoff Screws x4 (LGA 20XX)	p.	Fan Screws x12
g.	Standoff Screws x4 (LGA 115X/1200/1366)	q.	Radiator Screws x12
h.	Standoff Screws x4 (LGA 1700/1851)	r.	ARGB One-Click Controller x1
i.	Standoff Screws x4 (AMD)	s.	Thumbscrew Caps x4
j.	Standoff Screws x4 (TR4)	t.	Thermal Compound x1

Installation Guide



- * Please follow the related chapters to assemble.
- * Please use the original provided accessories to avoid damage to the product.

(1) Install AL120 Fans to Radiator

Parts Required : 240 mm/360 mm radiator, Luna AL120 Fans, Washers, Fan Screws

Note : Please be sure to use a washer on each screw before installation.

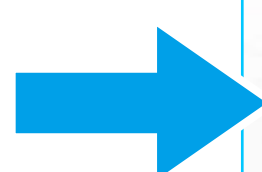
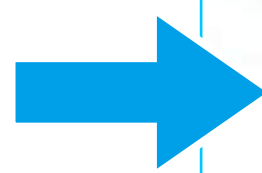

(2) Install Fans and Radiator combo to your PC chassis.

Parts Required : Radiator Screws



Installation Guide

(3) Installation for motherboards

A. For Intel Motherboards (LGA 115X/1200/1366/20XX/1700/1851)

(1) Switch the Intel backplate pins according to the CPU socket of your motherboard.

Note: Intel LGA 20XX does not require back plate installation.

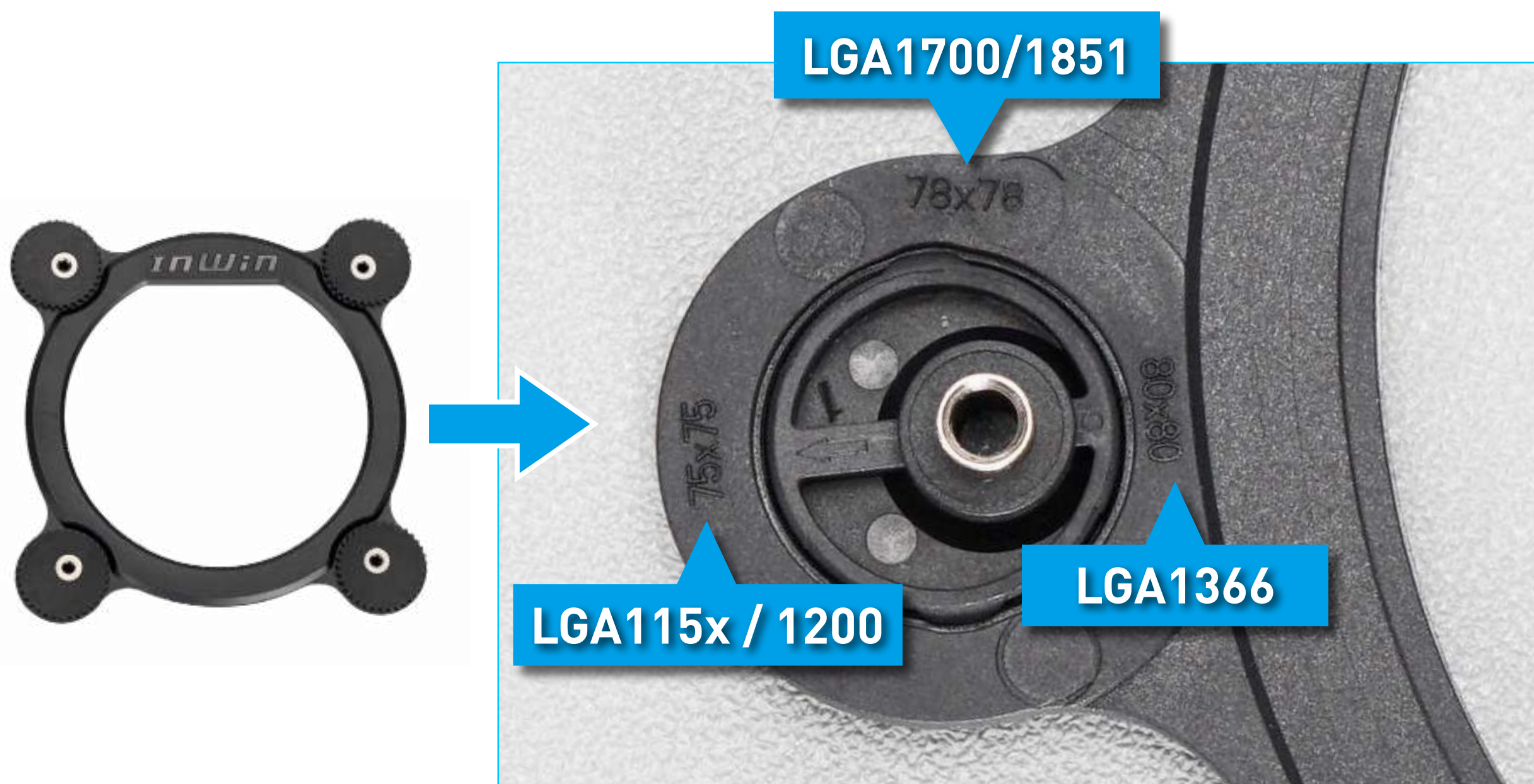

(2) Attach the Intel backplate to the bottom of the motherboard.

Note: Intel LGA 20XX does not require backplate installation.

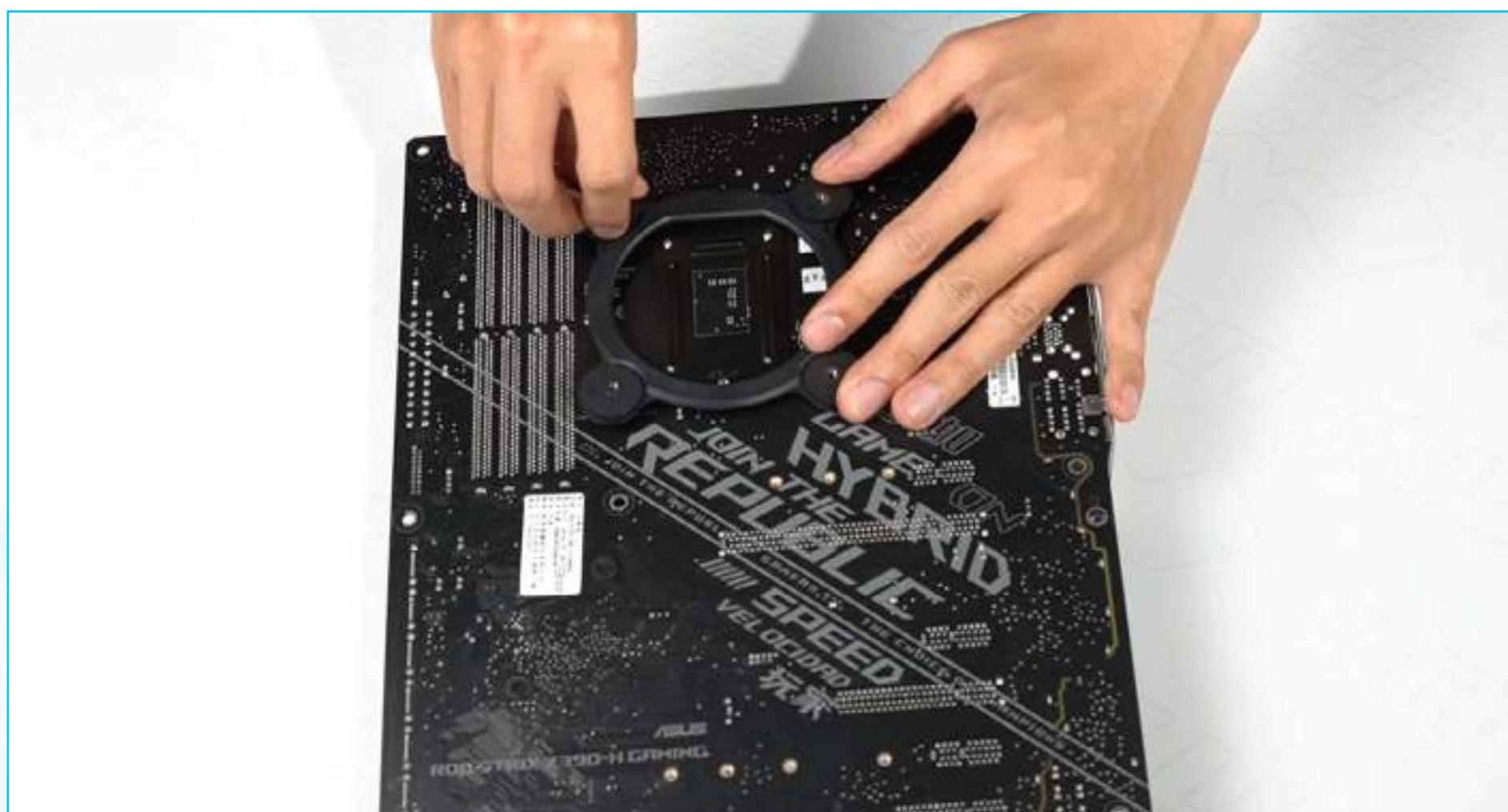

(3) Install the standoff screws onto your motherboard. Ensure to use the correct standoff screws for your CPU socket.

Parts Required : Standoff Screws (LGA115X/1200/1366/20XX/1700/1851)

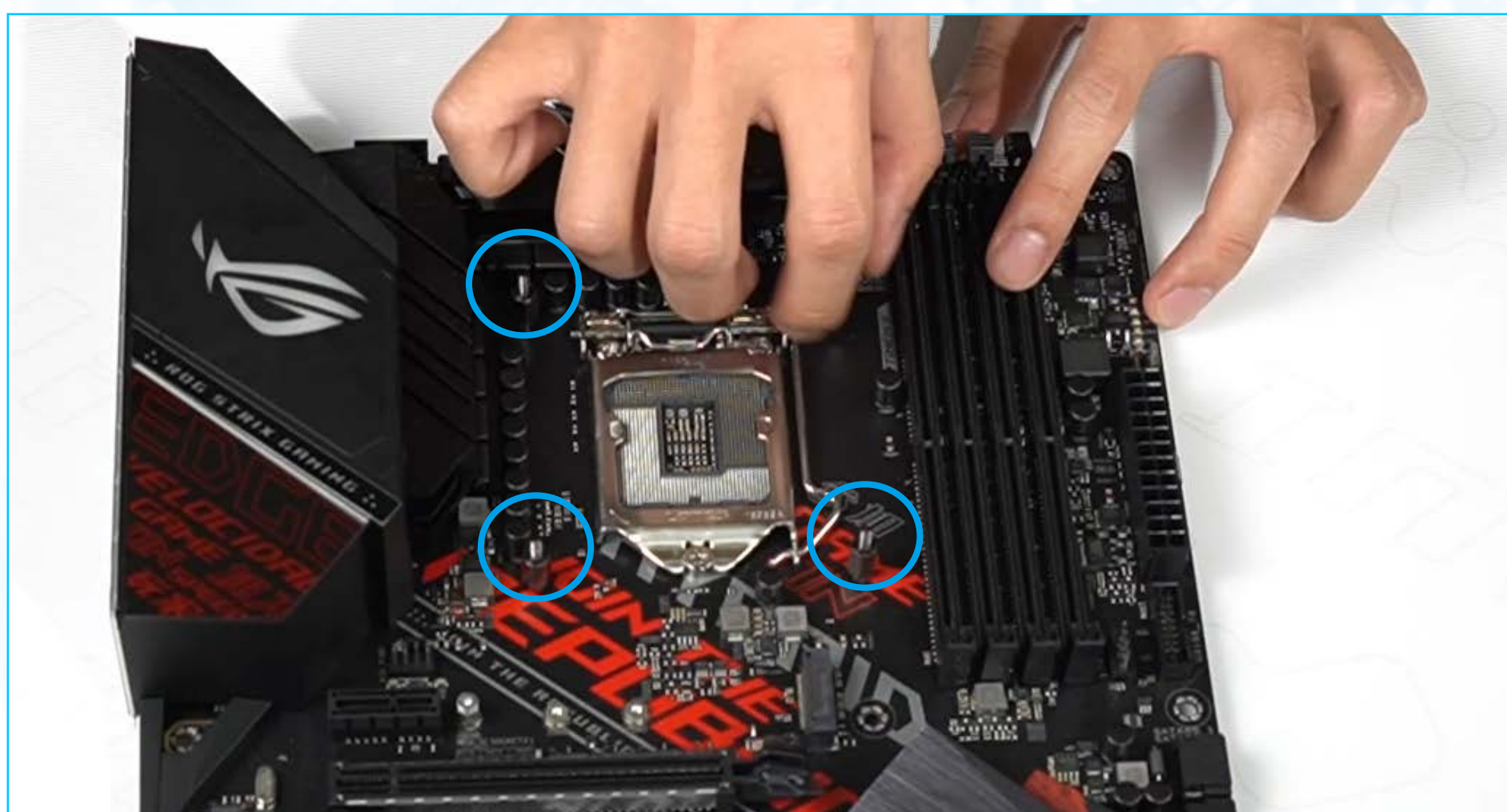

Installation Guide

B. For AMD Motherboards (AMD or TR4)

(1) Please remove the retention module. AMD's backplate comes with AMD's motherboard. Attach it to the bottom of motherboard.

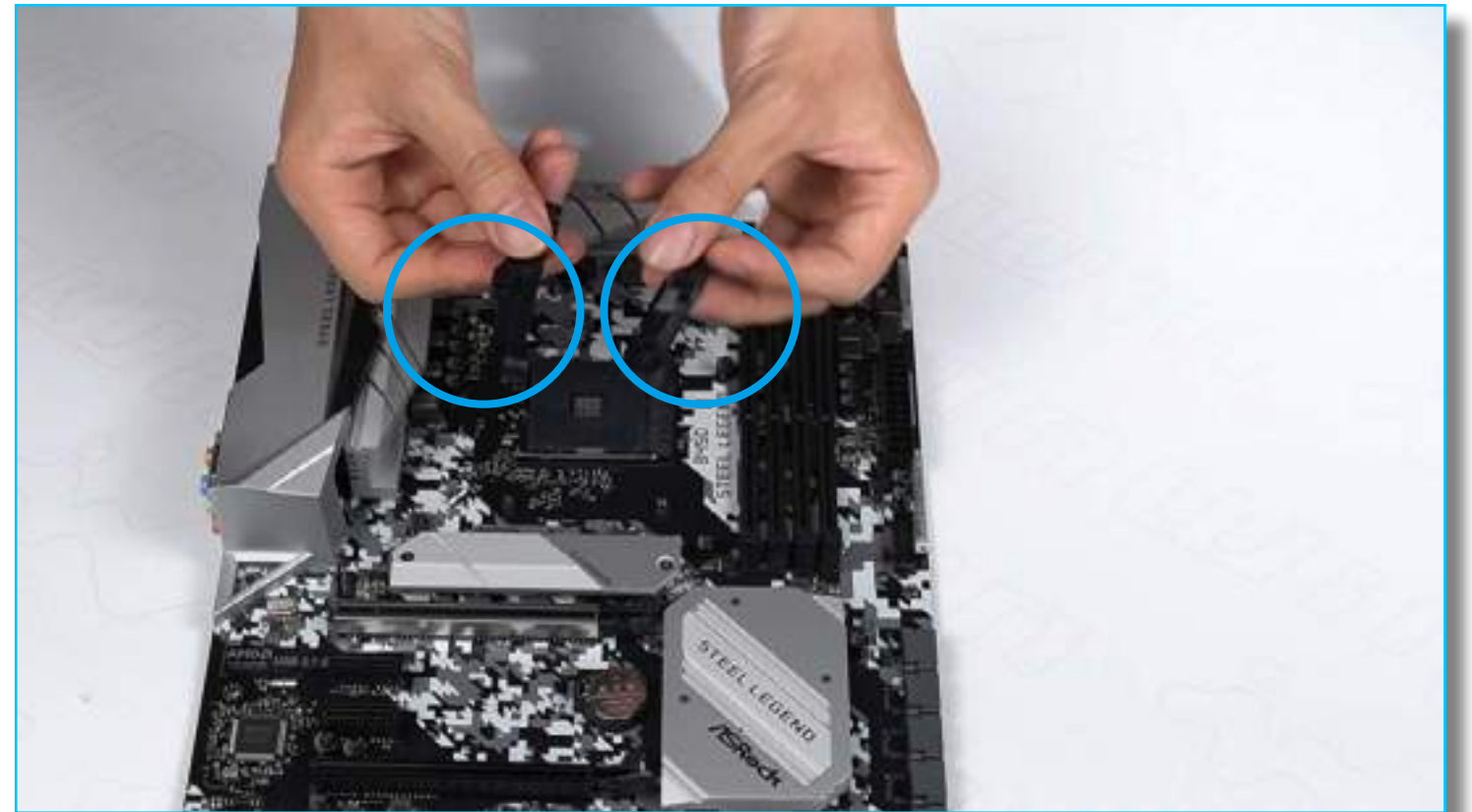
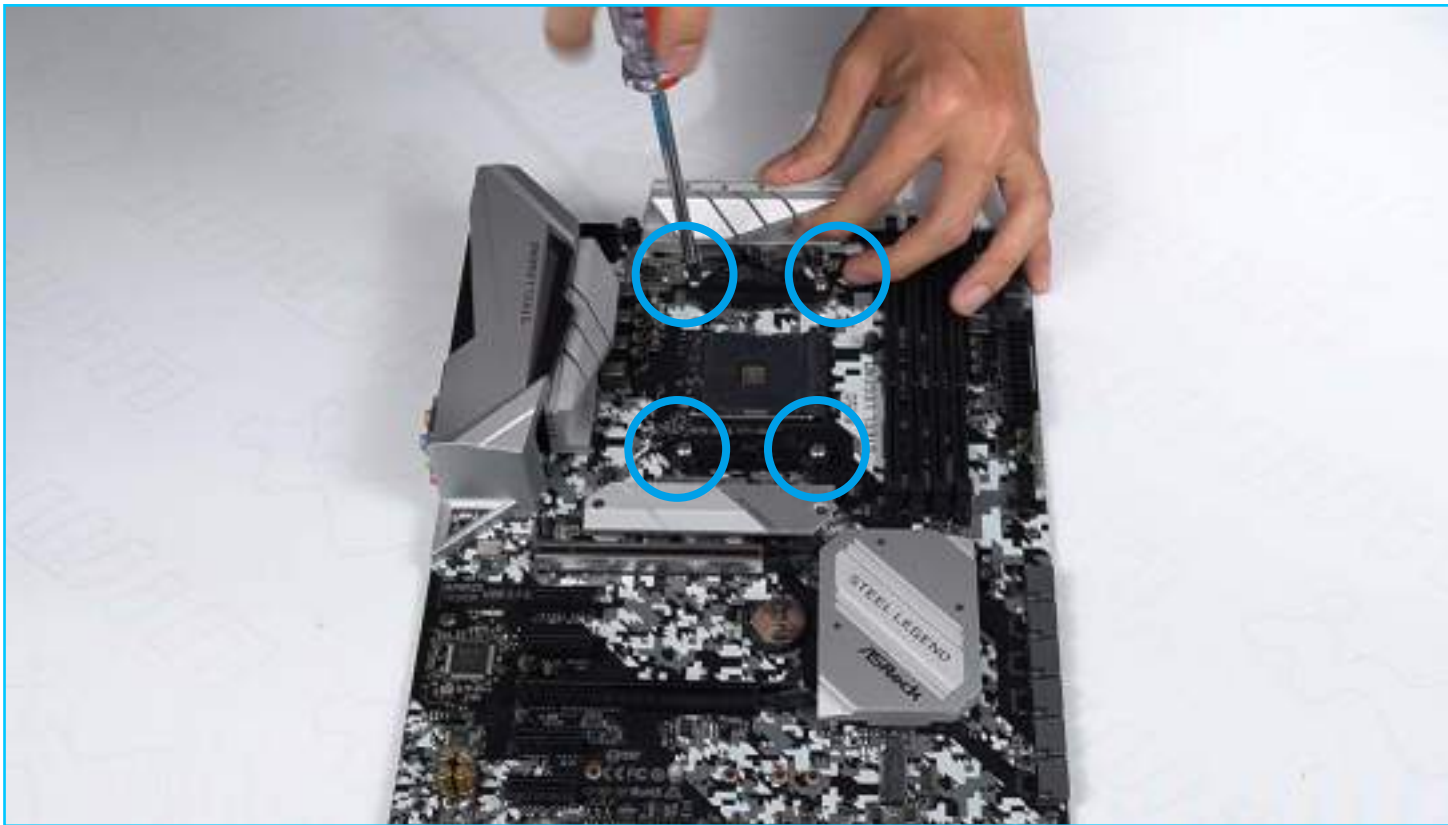

(2) Install the standoff screws onto your motherboard. Ensure to use the correct standoff screws for your CPU socket.

Parts Required : Standoff Screws (AMD or TR4)

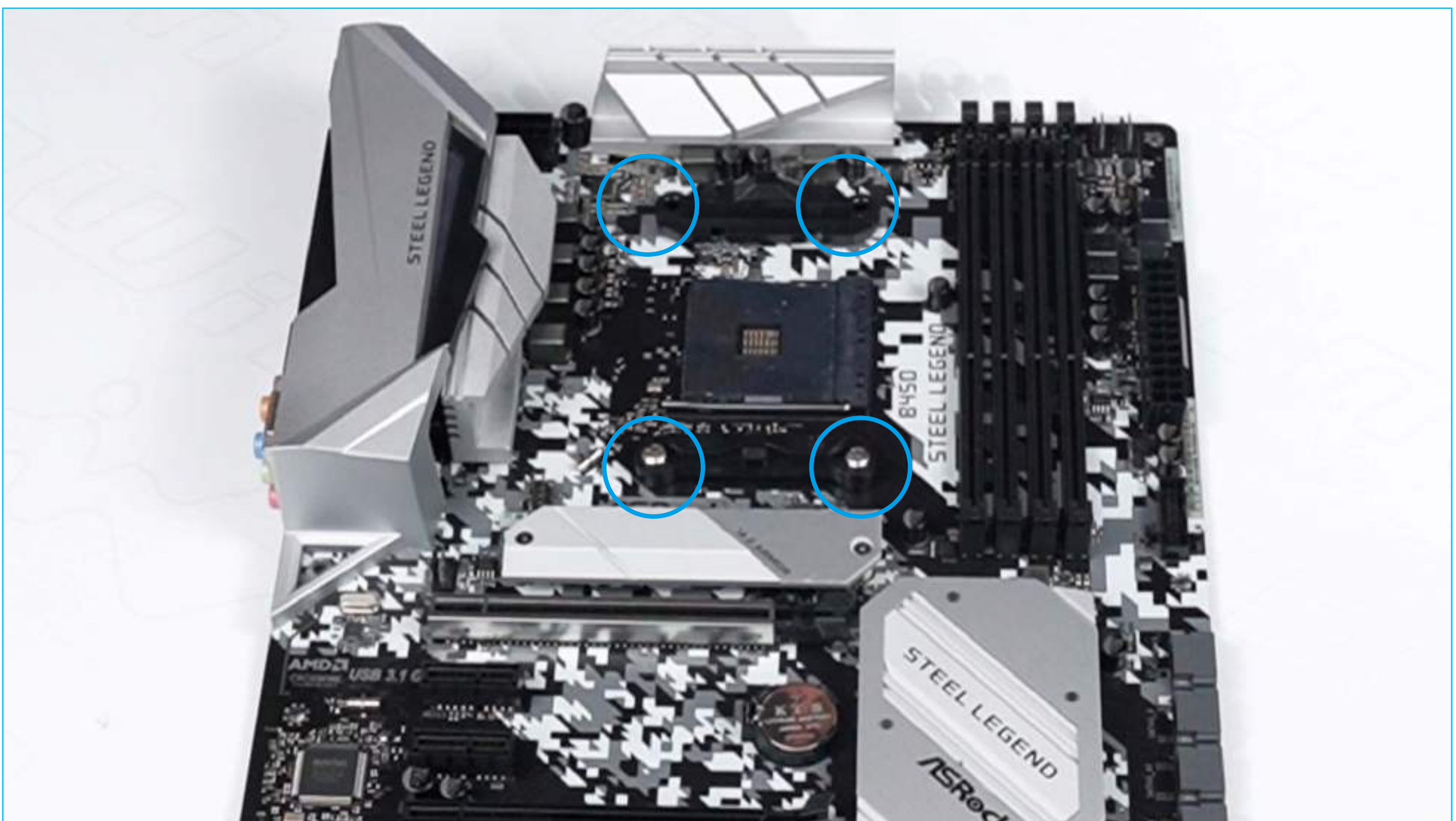

Installation Guide

(4) Install the Pump Unit

A. Choose your Mounting Bracket according to your CPU

Parts Required: Intel or AMD Mounting Brackets, Thumbscrew Cap, Thermal Compound

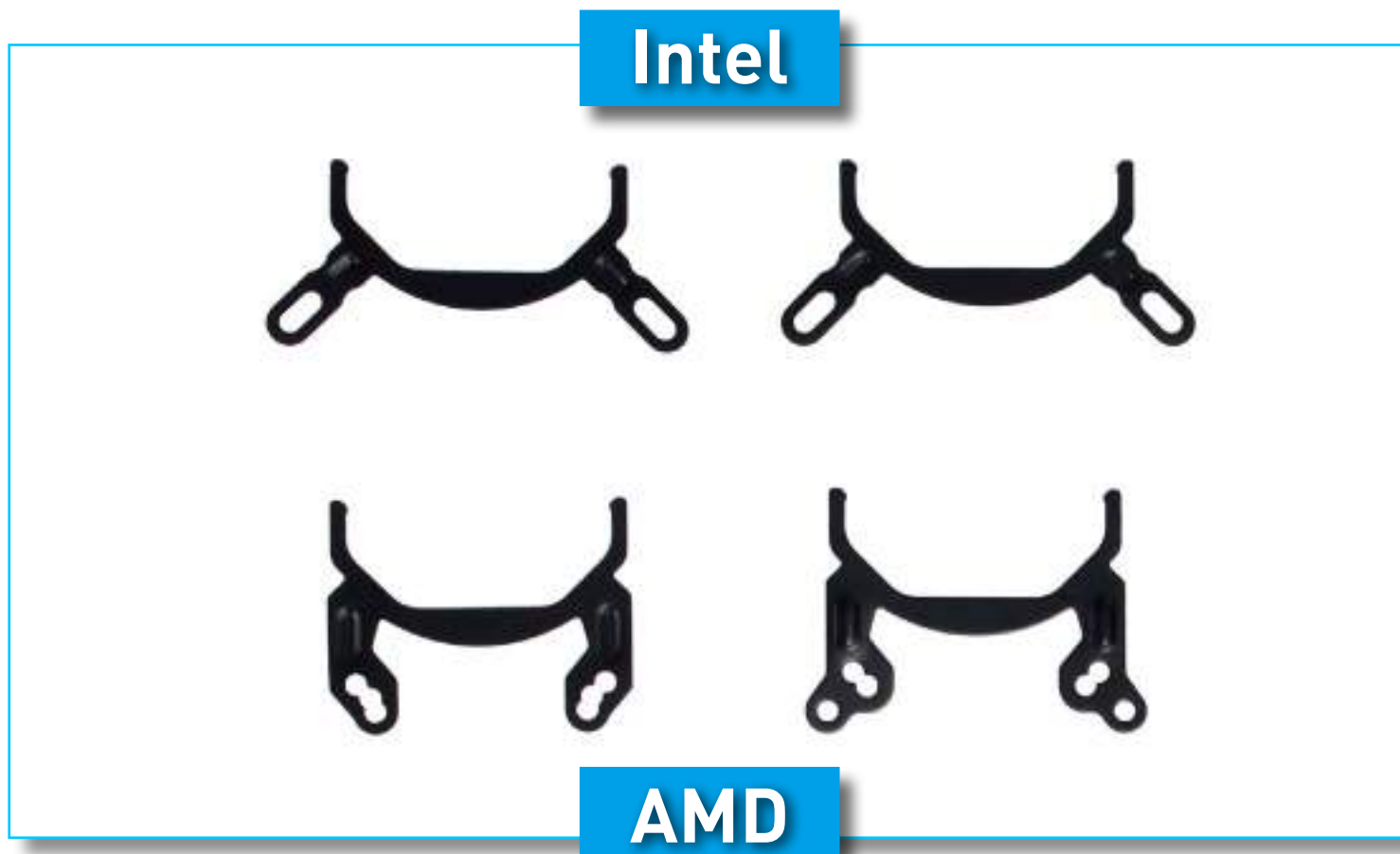

B. Apply the Thermal Compound evenly on the CPU surface

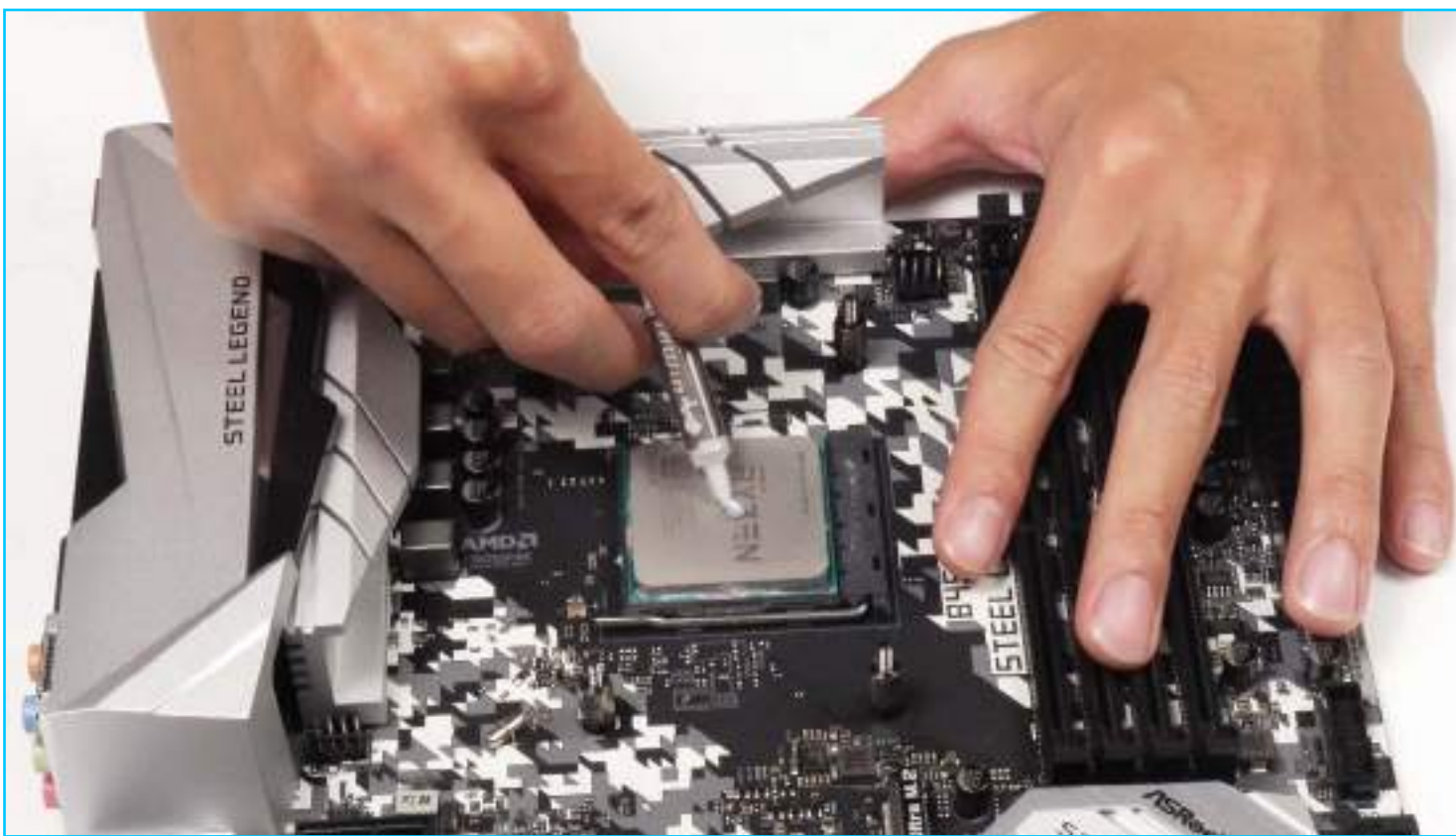

C. Remove the protect film from the cold-plate



D. Install the water block and then tighten it with the Thumbscrews

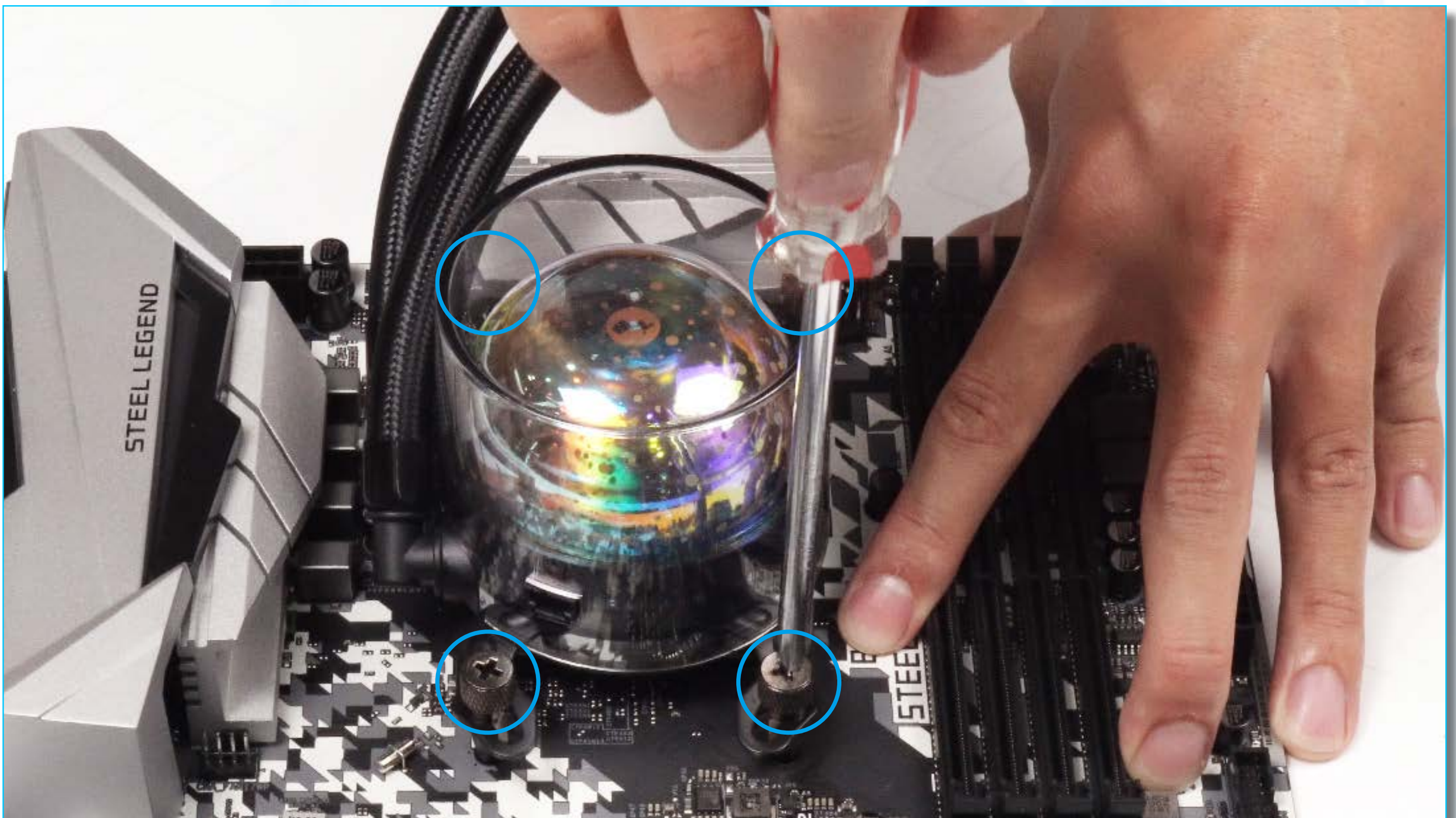

Installation Guide

(5) Connection Cables

Parts Required: PWM Fan Cable, ARGB Fan Cable, ARGB Water Block Cable, Pump Cable

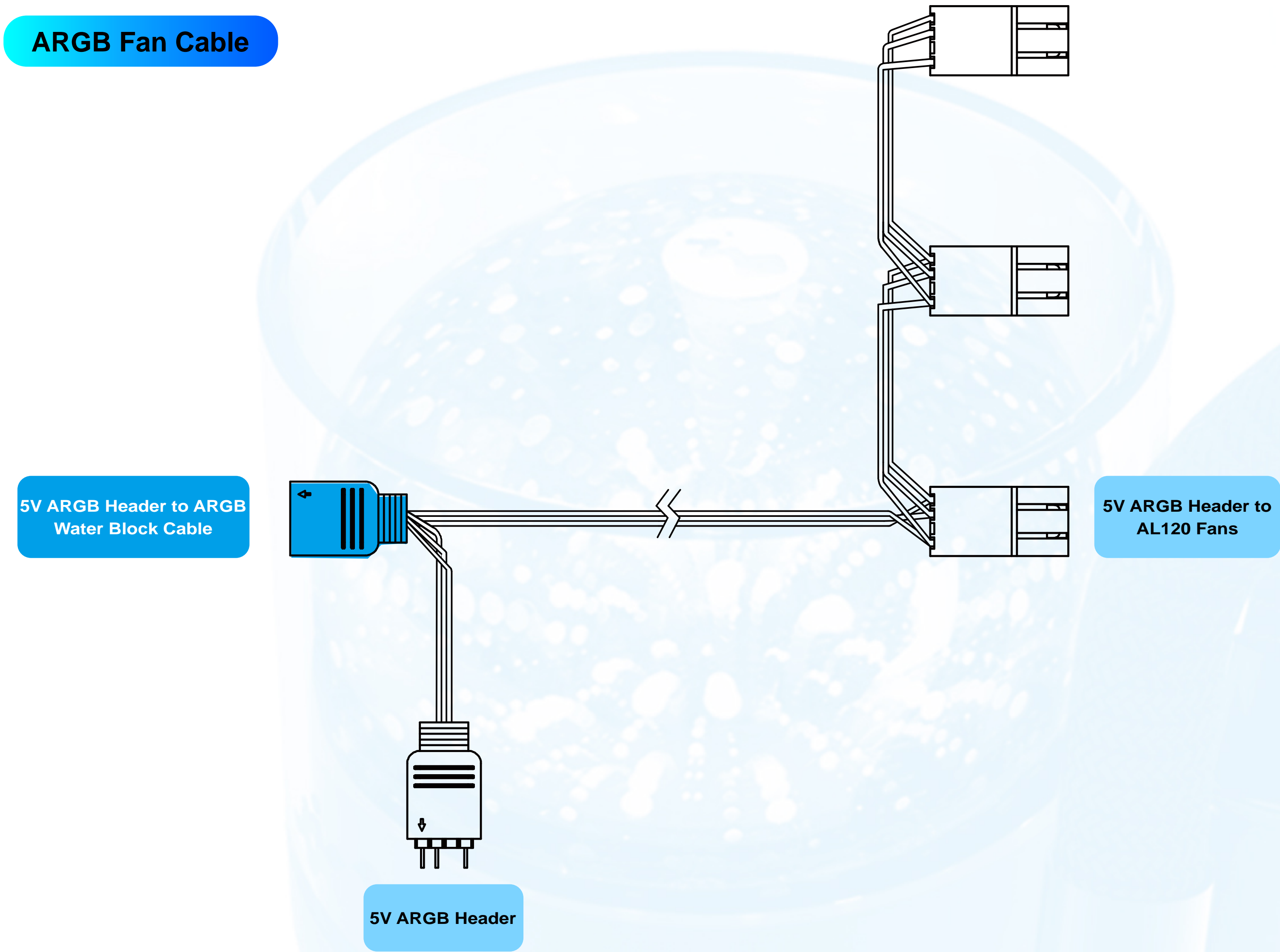
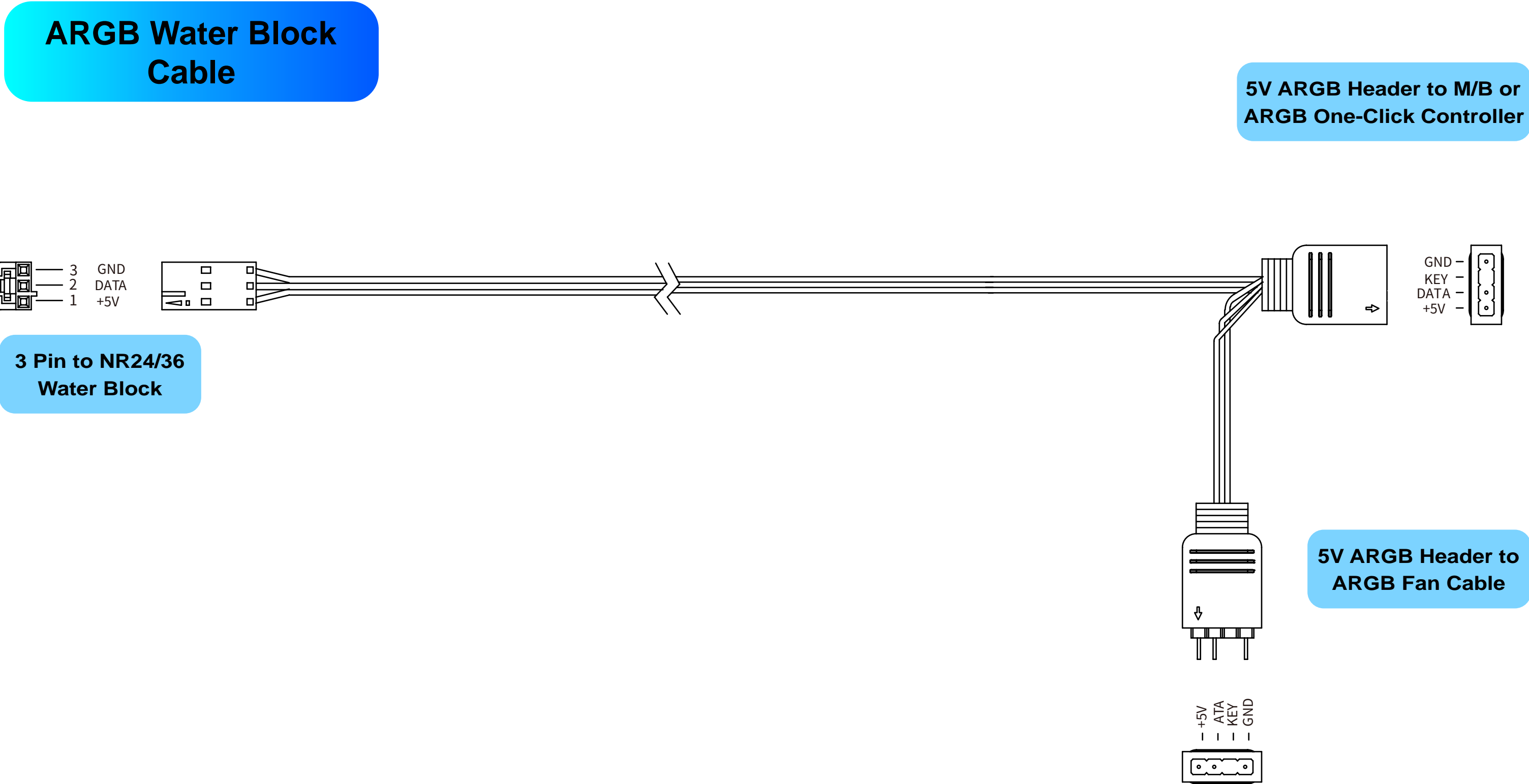

Installation Guide

PWM Fan Cable

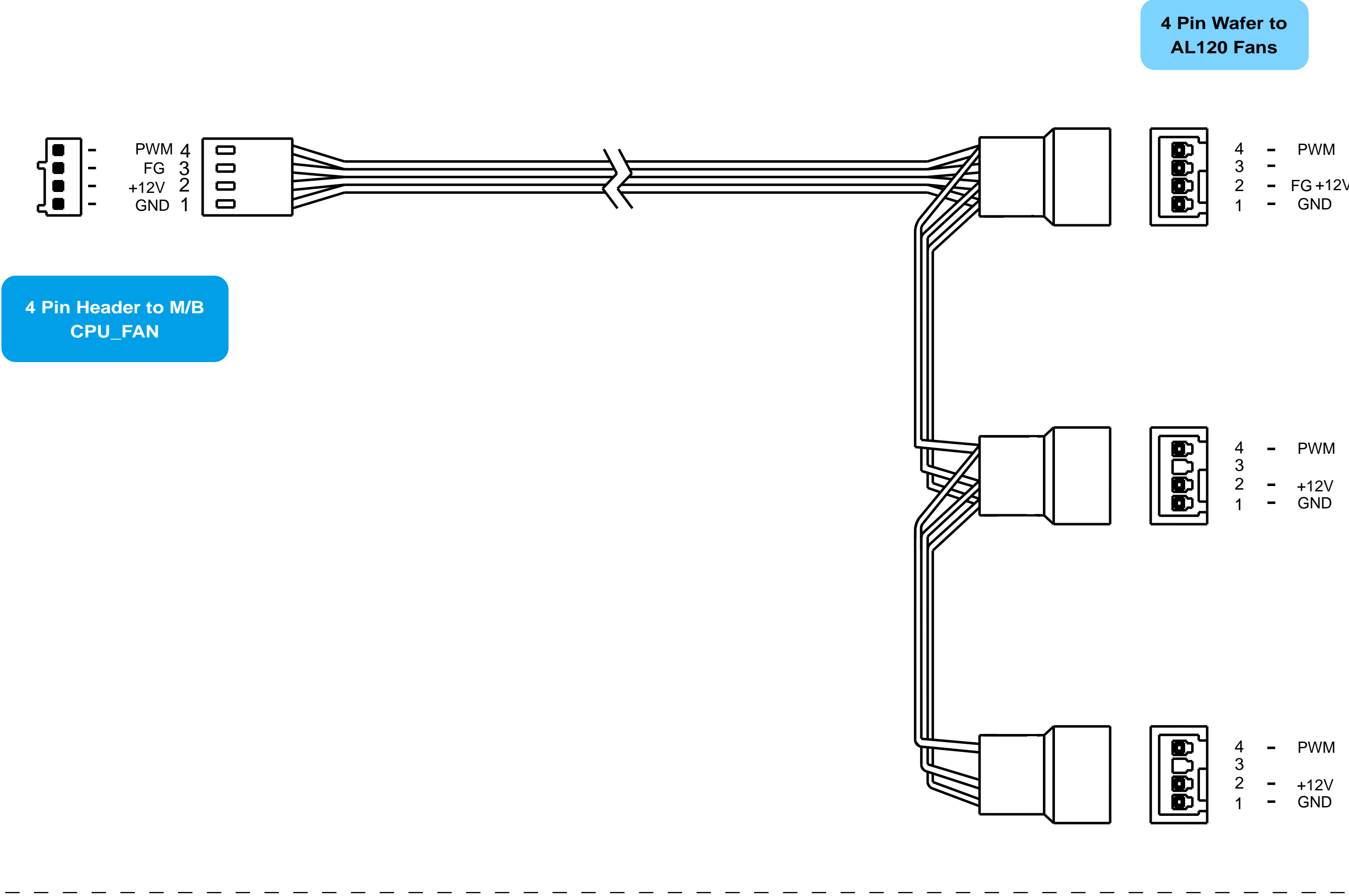

Pump Cable

* If your M/B does not have an AIO_Pump, you can connect the 3 Pin to a fan header, but it is recommended to set the output to DC 12V.

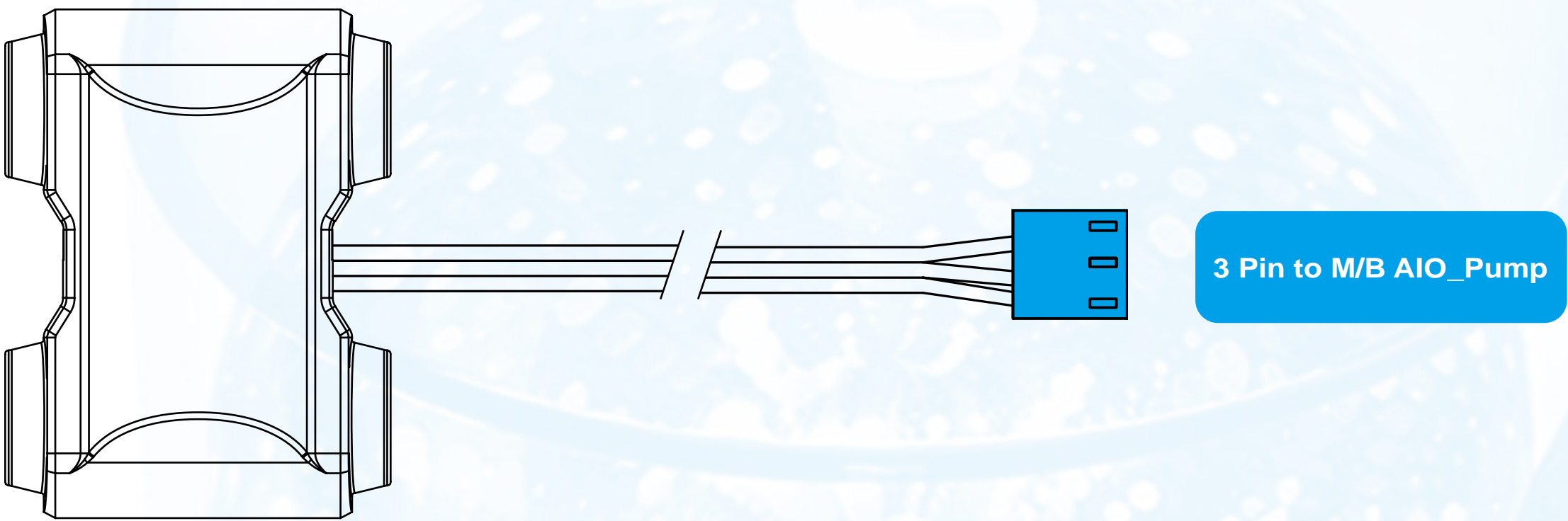

Installation Guide

(6) ARGB One-Click Controller Installation

If your motherboard does not support ARGB effects, please use the included ARGB One-Click Controller in order to use the 14 lighting modes.

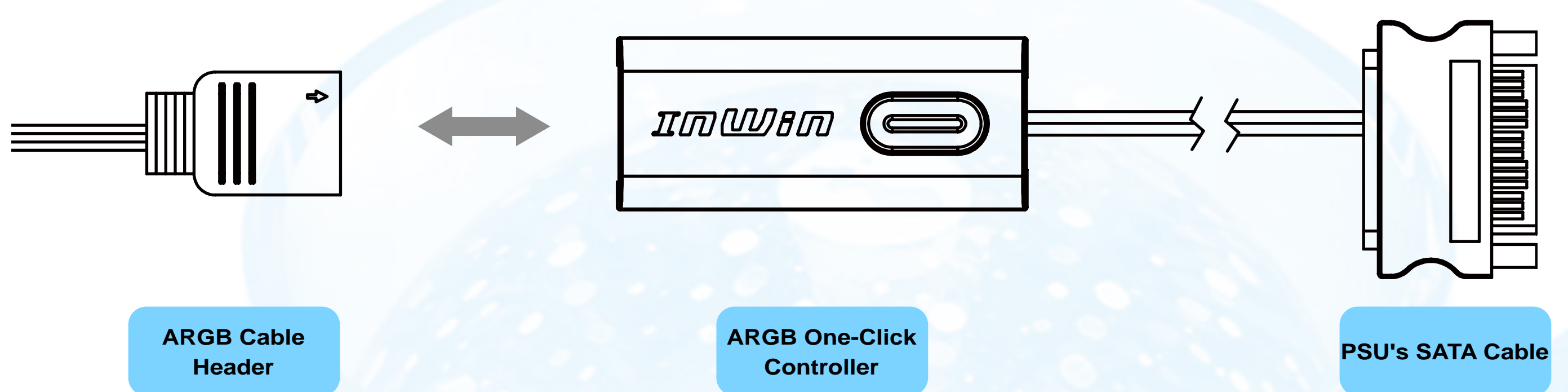
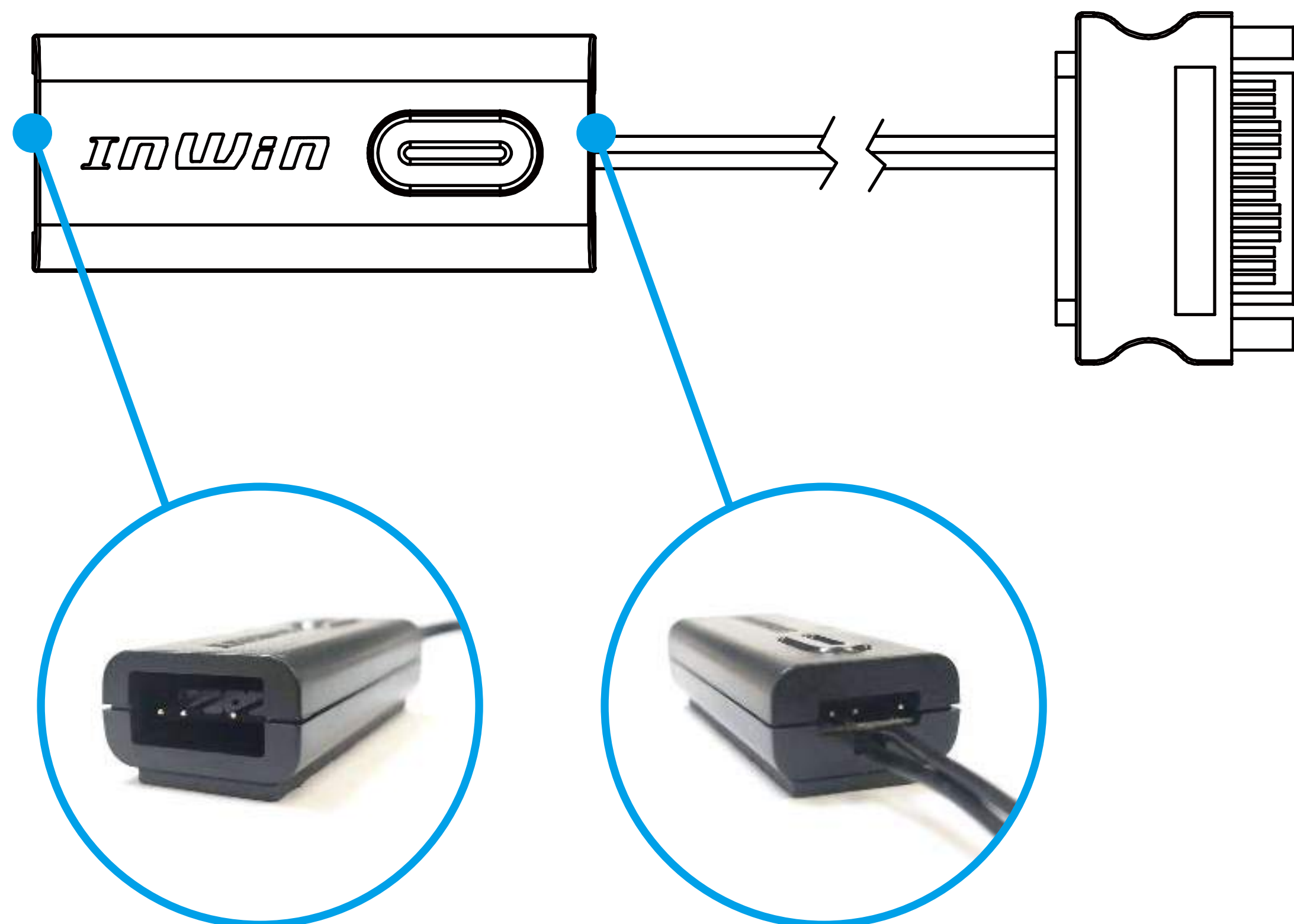

Installation Guide

Hold the button to turn on or off the lights. Tap the button to change the lighting modes.

1	Rainbow	8	Two-Tone Ring
2	LED-Red Breathing	9	Diagonal Transition
3	LED-Green	10	Rotating LED Trio
4	LED-Blue	11	Full Circle
5	LED-Purple	12	Flow-Red
6	LED-White	13	Flow-Green
7	Light at the end of the Tunnel	14	Flow-Blue

* InWin reserves the right to change the lighting modes.

Troubleshooting

■ **If your AIO pump or fan does not operate properly, please follow the instructions below :**

1. Please check your system's power.
2. Please make sure all the connectors are connected properly.
3. For more technical support, please visit the InWin Forum website at <https://forum.in-win.com/>

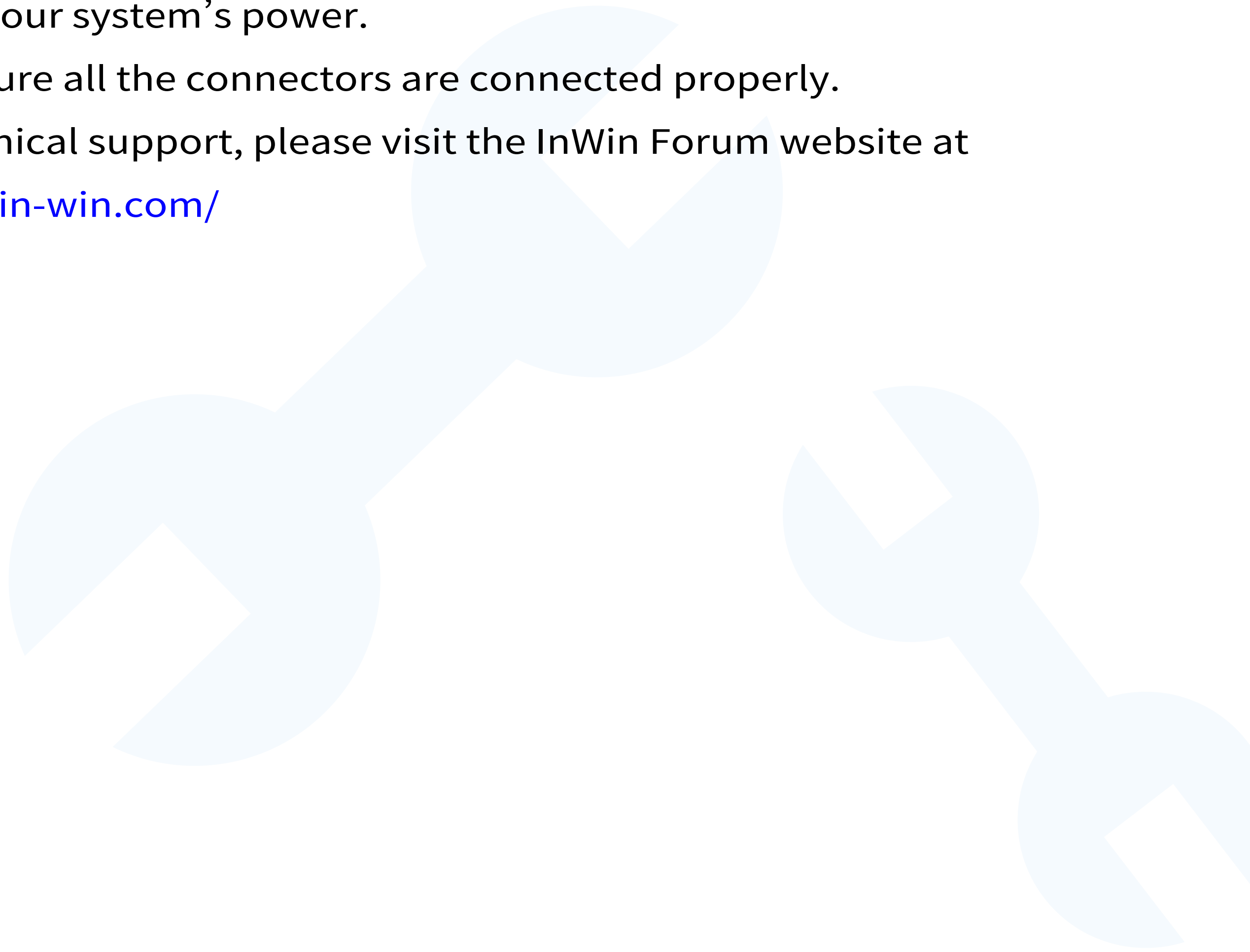

Notices and Warranty

■ Notices

1. Install in accordance with the user manual's instructions and safety warnings. Incorrect installation may burnout the motherboard and other system components.
2. Keep this product away from areas with high temperatures such as: heat dissipation machines, air conditioners or other machines which may generate high temperatures.
3. Please do not put anything in the impeller.
4. Do not modify the cables and/or connectors included with this product.
5. Please do not put your hands or other objects into the fan blades when the fan is in operation. And please make sure to keep away from children and pets.
6. Please only use this product in a computer case.
7. Please keep this product away from any liquids.
8. Please use only this product's exclusively supplied cables. Other cables may not be compatible and could cause serious damage to your system and power supply

■ Warranty

1. For more detailed warranty information, please visit the InWin retail website at www.in-win.com
2. The actual product is subject to change without prior notice.
IN WIN DEVELOPMENT INC. reserves the right to make any final modifications.



inWin

CONTEMPORARY & INNOVATIVE
www.in-win.com